

**S** Single Cavity Application

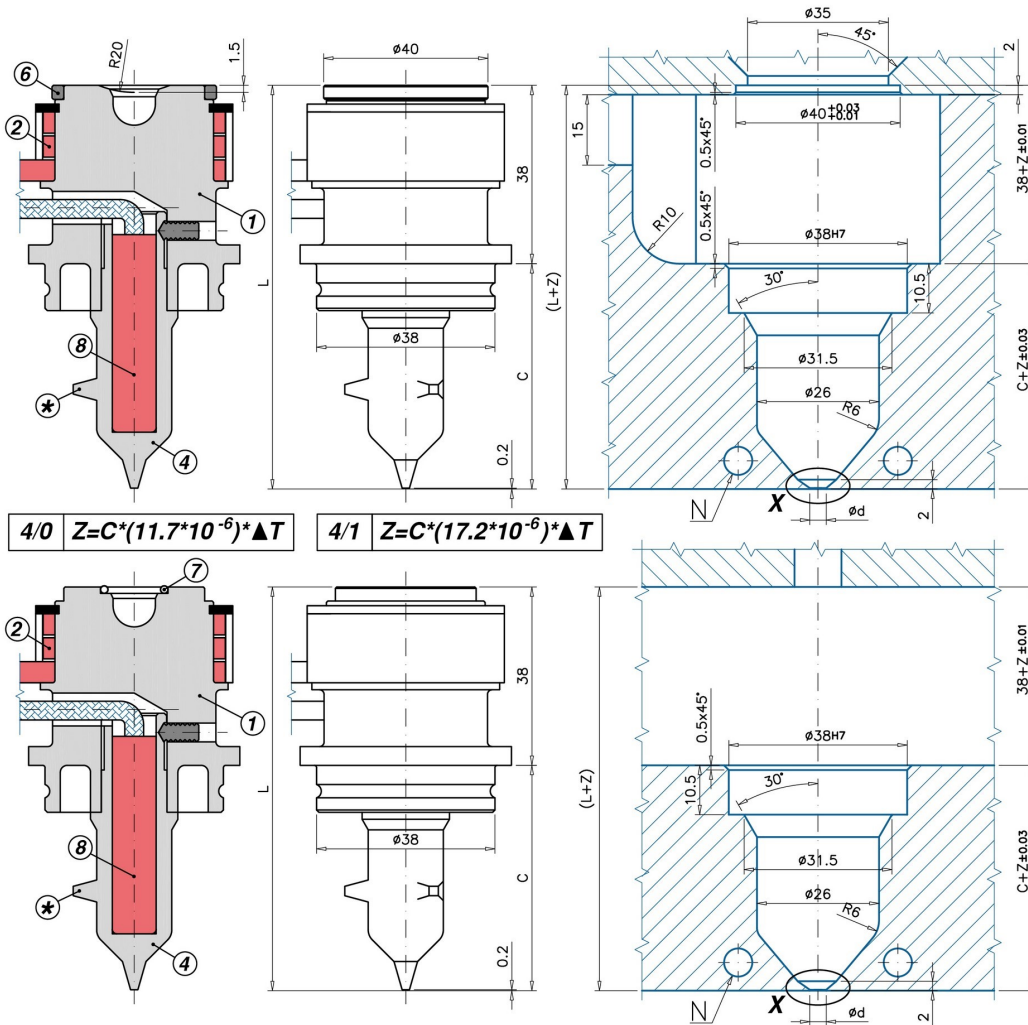

**M** MultiCavity Application

Code		L - C	1	2	4/0	4/1	6	7	8
UGGS4510MA	0/1	C=48 L=86	UGCRG45	REPTS350	UGPG4010	UGPG4110	-	UGACOR11	0950044B0300X
UGGS4510SA	0/1	C=48 L=86	UGCRG45	REPTS350	UGPG4010	UGPG4110	UGAS4030	-	0950044B0300X
UGGS4520MA	0/1	C=60 L=98	UGCRG45	REPTS350	UGPG4020	UGPG4120	-	UGACOR11	0950051B0300X
UGGS4520SA	0/1	C=60 L=98	UGCRG45	REPTS350	UGPG4020	UGPG4120	UGAS4030	-	0950051B0300X
UGGS4530MA	0/1	C=72 L=110	UGCRG45	REPTS350	UGPG4030	UGPG4130	-	UGACOR11	0950064B0350X
UGGS4530SA	0/1	C=72 L=110	UGCRG45	REPTS350	UGPG4030	UGPG4130	UGAS4030	-	0950064B0350X
UGGS4540MA	0/1	C=84 L=122	UGCRG45	REPTS350	UGPG4040	UGPG4140	-	UGACOR11	0950076B0400X
UGGS4540SA	0/1	C=84 L=122	UGCRG45	REPTS350	UGPG4040	UGPG4140	UGAS4030	-	0950076B0400X

INJECTION VESTIGE: T2 DIRECT INJECTION TORPEDO NOZZLES WITH HEATED HEAD - YES: Minimum injection vestige - YES: plastics that leave stringings/droolings while mould opens - YES: abrasive reinforcements (choose the 4/0 tip) - YES: SINGLE AND MULTY-CAVITY applications - NO: colour change

- 1 = Nozzle body
- (M=MultiCavity / S=Single Cavity)
- 2 = Coil heater with J-type thermocouple
- 4/0 = Tempered steel torpedo
- 4/1 = Cu-Be torpedo
- 6 = Centering Ring
- 7 = O-Ring
- 8 = Cartridge heater with J type TC
- Ød= Standard : 1,0 ÷ 1,5
- Centering on request

